

# GreenLine

**PREMIUM SLURRY PUMPS**

*DARITECH*



From its inception in 1990 with one man in a service van, to the industry leader in innovative dairy solutions that DariTech is today, we have always strived for the best performance from our systems. Our equipment is developed through the ingenuity of our design team while incorporating the input of users to meet the demands in the field. The efficiency and effectiveness of our systems and equipment is unsurpassed.

Our GreenLine pumps follow in the DariTech tradition of bringing value to dairies throughout North America by providing long wearing, highly efficient solutions to the many challenges that manure handling presents. Our pump line offers a broad selection of innovative features for demanding dairy applications. With the ability to configure our pumps for a wide range of flow rates, and manure consistency, we can handle manure pumping requirements of any operation.

From impellers designed for low turbulence and wear, to heavy duty shaft bearing assemblies, GreenLine pumps are built to last. With experience in numerous applications of GreenLine pumps, going back to 1995, we continue to bring innovative solutions and continued improvement to dairy operations. You can be sure we will always be looking to the future, keeping up with the growing demands of dairying worldwide.



**Diesel Pump Drive**  
GreenLine 6X5X14 Pump  
250 Series



**Electric Pump Skid**  
GreenLine 8X6X14 Pump  
250 Series



GreenLine 250 Series Pump



GreenLine 118 Series Pump



**Electric Pump Skid**  
GreenLine 4X3 Pump  
118 Series



Separator feed pump in drywell for lower horsepower usage and longer life expectancy. Using GreenLine 8X6X14 pumps.



GreenLine 10X8X14 Flush pumps for two 7,000 cow dairies with back-up pump.

The GreenLine Pump line offers a full range of pump sizes and horsepower to meet your requirements. We can accommodate your pump needs, with anything from a half horsepower pump to move fifty gallons per minute in our 118 series, to two hundred horsepower to move five thousand gallons per minute in our 250 series. With GreenLine's robust casting and exacting tolerance specifications, we can ensure proper performance and reliability for years to come.

Please refer to our Pump Selection Guide for a full list of curves.

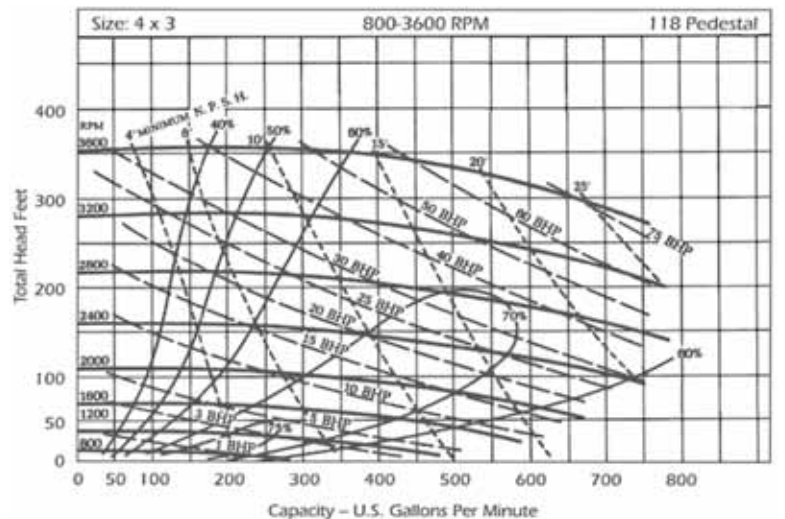
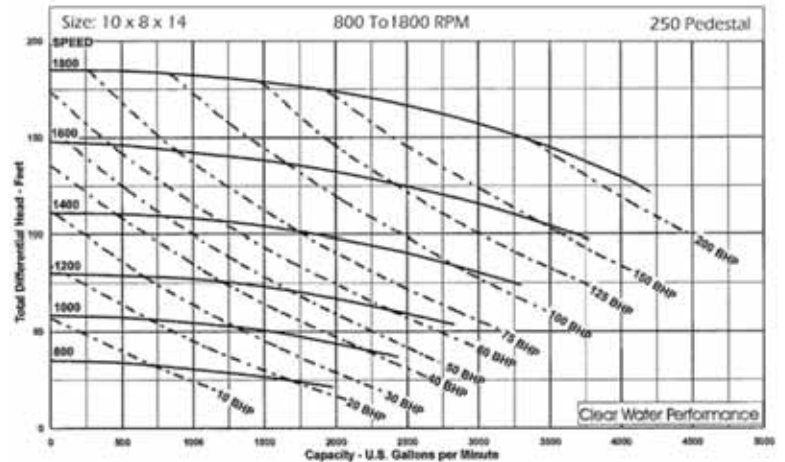
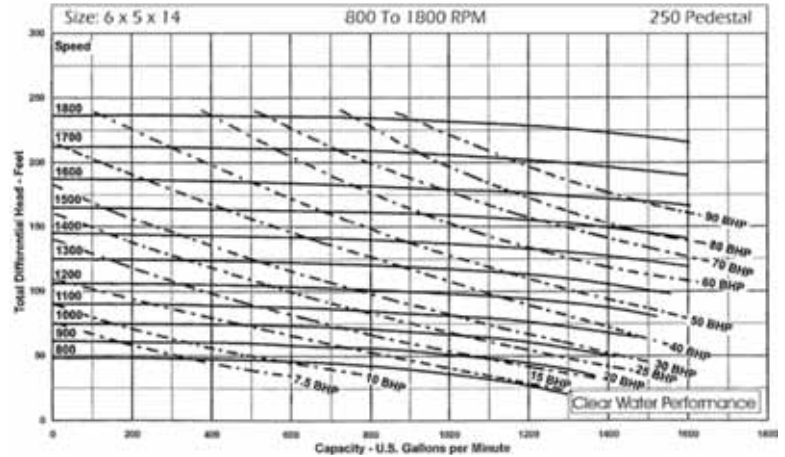
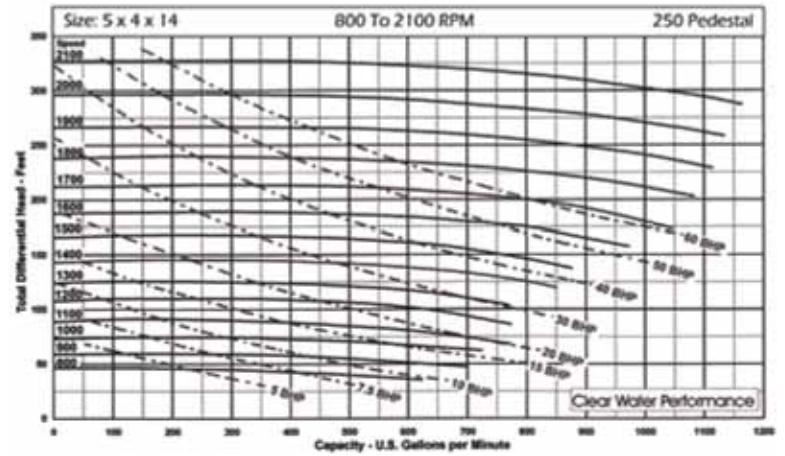

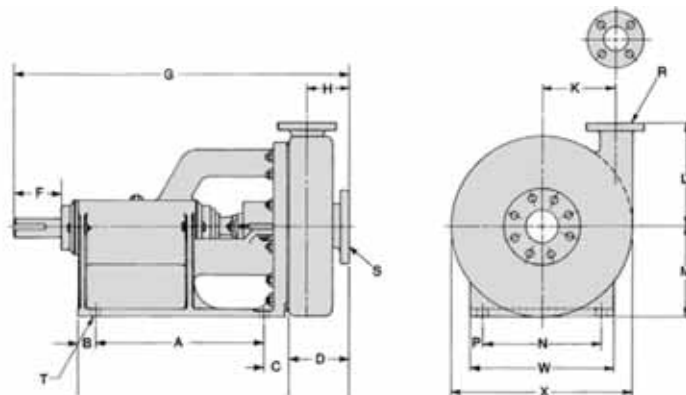

**118 PEDESTAL, HOUSING & INSTALLATION DIMENSIONS**

Pump Size	A	B	C	D	F	G	H	K	L	M	N	P	R	S	T	W	X
2 X 1 1/2	13	1 7/16	2 3/8	5	3 5/16	26 3/4	3 1/2	4 5/8	7 1/16	7	4 1/4	7/8	1 1/2	2	(4)- 11/16	6	12
3 X 2	13	1 7/16	2 3/8	5 1/2	3 5/16	27	3 3/4	5 1/2	7 3/4	7	4 1/4	7/8	2	3	(4)- 11/16	6	12
4 X 3	13	1 7/16	2 3/8	6 5/8	3 5/16	28 1/2	4 1/4	5	8	7	4 1/4	7/8	3	4	(4)- 11/16	6	12 3/4

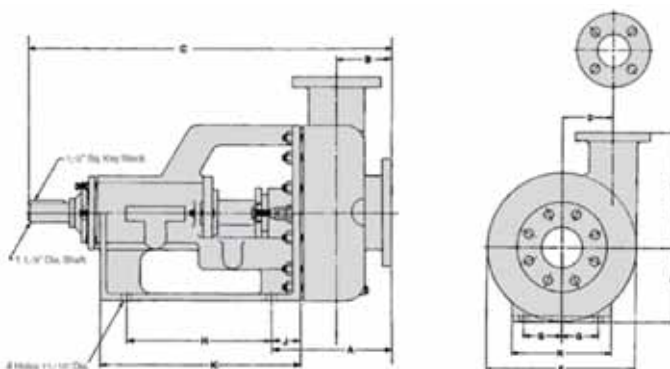

**250 PEDESTAL, HOUSING & INSTALLATION DIMENSIONS**

Size Dimensions	3X2X13	4X3X13	5X4X14	6X5X11	6X5X14	8X6X11	8X6X14	10X8X14
A	8 3/4	9 3/8	10 3/4	12 1/16	12 1/16	13 1/4	13 1/4	13 11/16
B	3 3/4	4 1/4	5	5 3/4	5 3/4	6 3/4	6 3/4	6 11/16
C	33	33 5/8	35	36 3/8	36 3/8	37 1/2	37 1/2	37 15/16
D	7	6 3/4	6 1/8	6	6	8 3/8	8 3/8	8
E	10 1/4	10 1/4	11	11	11	14	14	14 3/16
F	17 7/8	17 7/8	19	17 7/8	21	20	23	22 3/8
G	3 1/2	3 1/2	3 1/2	3 1/2	3 1/2	3 1/2	3 1/2	3 1/2
H	15 7/16	15 7/16	15 7/16	15 7/16	15 7/16	15 7/16	15 7/16	15 7/16
J	2 5/16	2 5/16	2 5/16	2 5/16	2 5/16	2 5/16	2 5/16	2 5/16
K	19 5/8	19 5/8	19 5/8	19 5/8	19 5/8	19 5/8	19 5/8	19 5/8
M	9	9	9	9	9	9	9	9
N	9	9	9	9	9	9	9	9
Max Impeller Dia.	13	13	14	11	14	11	14	14
Min Impeller Dia.	6	6	7	8	10	8	10	12
Suction Size	3	4	5	6	6	8	8	10
Discharge Size	2	3	4	5	5	6	6	8
Weight - Lbs.	430	440	490	520	550	610	630	810

